

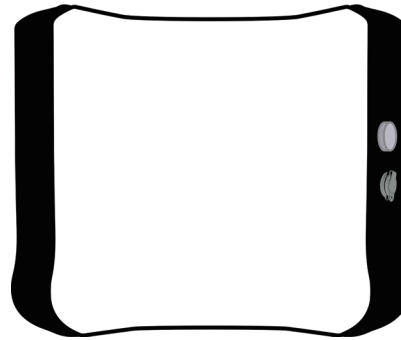

# PHEON LUX<sup>®</sup>

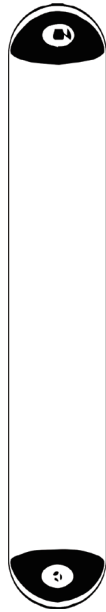
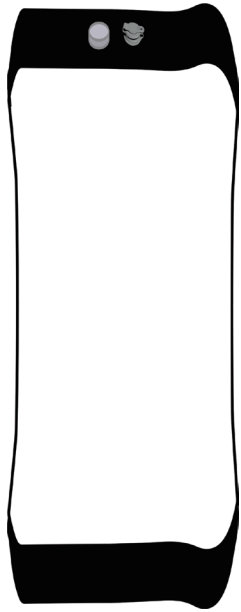

## AIR LUX MAX Series

### Product User Manual

## ■ Foreword

Thank you for purchasing the full-color Pixel Inflatable Light M-Max Series from Huiguan Culture Technology. This product features an automatic/manual inflation design, with 23 built-in special effects modes and over 600 electronic color gels. It delivers color temperatures ranging from 1700K to 20000K,  $\pm 100$  red Green Balance, The MAX Series introduces a new XY-Axis System. It incorporates an internationally compatible communication module and multiple protocols, control options include: Light body controls, Pheon Link APP, DMX512, Dedicated controllers, Wired/wireless CRMX, Additionally, the Pheon Link APP includes light libraries from other brands to meet professional film and television production demands.

All products come standard with controllers, frames, egg grids, connecting cables, and DC/AC air pumps to empower extraordinary creations. The Pixel Inflatable Light MAX series comprises 11 models, offering large, medium, and small sizes to flexibly adapt to diverse application scenarios.

## ■ Important Notes

1. Please stay away from corrosive chemicals and liquids to prevent product damage.
2. When using the product, please arrange the power cord properly to avoid tripping, which may result in power interruption or damage to the product.
3. Do not disassemble the product by yourself, as this will void the warranty. For malfunctions, have the product inspected or repaired by authorized technicians.
4. Dropping or external impacts may cause product malfunction. Damage caused by human factors is not covered under our company's warranty.

## Light Specifications

Light Source	RGBWW
Voltage	AC 100V-240V DC 14.8V-26V
Light Size	M14C Max 1220mm*Ø250mm M18C Max 2230mm*Ø250mm M22C Max 660*610*150mm M24C Max 1150*550*150mm M44C Max 1170*1140*150mm M28C Max 2190*550*150mm M44C Max 1170*1140*150mm M48C Max 2200*1140*150mm M88C Max 2230*2230*150mm M116C Max 4200mm*Ø250mm M128C Max 8210mm*Ø250mm M216C Max 4200*550*150mm
Watta	M14C Max 100W; M18C Max 200W; M116C Max 400W M22C Max 100W; M24C Max 200W; M28C Max 400W M44C Max 400W; M48C Max 800W; M88C Max 1600W M128C Max 800W; M216C Max 800W
CCT	1700K-20000K
G/M Balance	±100
Color Rendering Index	CRI/TLCI ≥95

# Product Configuration

Lamp head	Controller	AC cable	Signal cable
			
AC/DC pump	Protective mat	Lamp holder	USB data cable
			
Braided tape/Velcro strap	Fabric Control Grid/Skirts	Flight Case	User Manual
			

Note: Different lamp head models come with different flight case, subject to actual delivery

# Installation Method

## 1. Light Fixtures and Power Connections

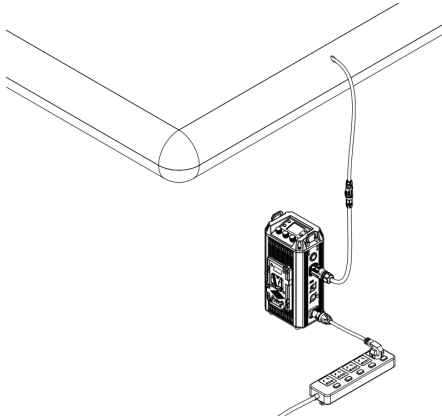

## 2. Luminaire to Battery Connection

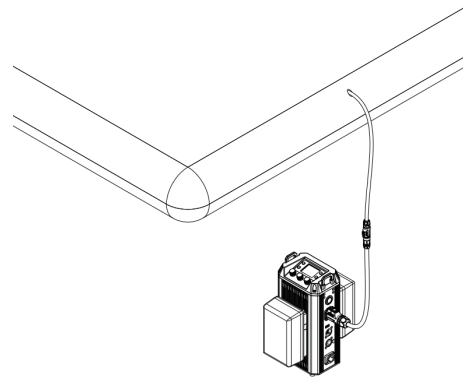

### 1. When connecting to power supply:

- 1.1 Ensure the power supply voltage and frequency match those specified on the controller.
- 1.2 Use only the supplied power cord and controller. Connect the controller's power plug to the lamp socket as shown in the diagram above.

### 2. When connecting to the battery:

- 2.1 When installing the battery, avoid applying excessive force to prevent damaging or deformation of the battery holder.
- 2.2 When removing the battery, press the battery lock release button to avoid damaging the battery compartment.
- 2.3 The Sony battery mount is compatible with 14.4V-14.8V/26V Sony V-mount batteries.

### 3.Lamp holder Installation Method

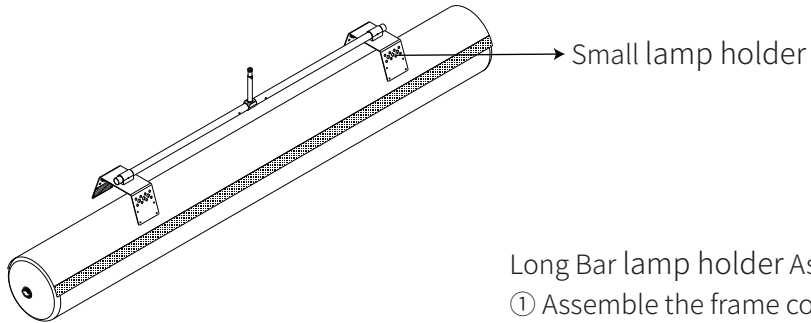

Long Bar lamp holder Assembly Steps:

- ① Assemble the frame completely.
- ② Place two small lamp holder on both sides of the light body and press down firmly until secured.

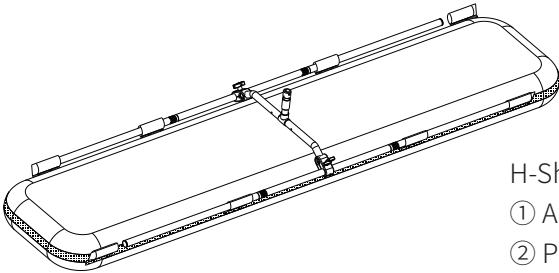

H-Shaped lamp holder Assembly Steps:

- ① Assemble the frame completely.
- ② Place the frame beneath the lamp body and peel off the velcro strap on the lamp body.
- ③ Loop the fuzzy side of the velcro strap around the frame to the connection point, then straighten the hook side and press it onto the fuzzy side.

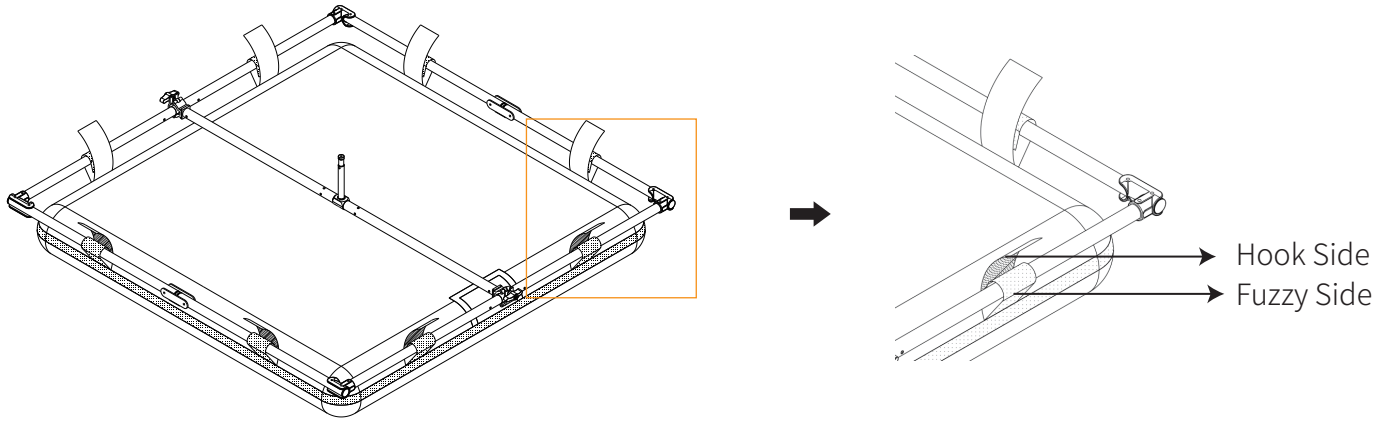

### Square lamp holder Assembly Steps:

- ① Assemble the frame completely.
- ② Position the frame beneath the lamp body and peel off the hook-and-loop tape from the lamp body.
- ③ Loop the hook-and-loop pile side around the frame to the connection point, then straighten the hook side and press it onto the pile side.

#### 4.Skirt Installation Method

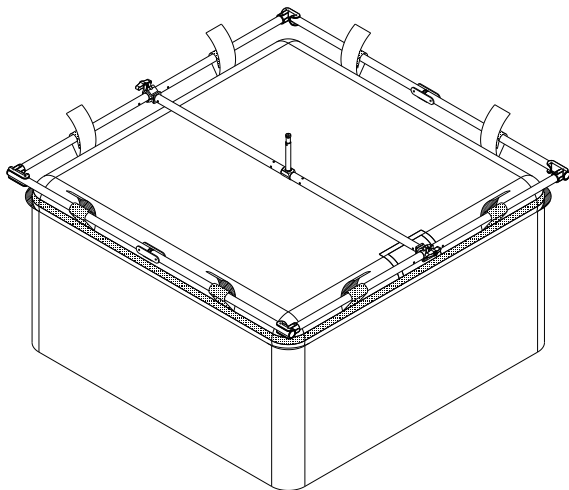

▲Unfold the skirt and adhere it along the fuzzy side around the lamp body.

#### 5.Grid Installation Method

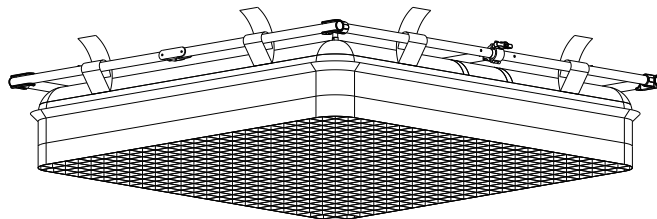

▲Unfold the grid and adhere it along the fuzzy side around the lamp body.

# Inflation Demonstration

## 1.AC air pump Inflation

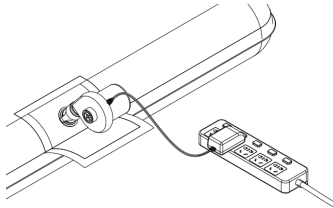

1. AC air pump Inflation Operation Method:

- 1.1 Open the inflation valve cap on the top of the light body.
- 1.2 Insert the air nozzle into the “air outlet” of the electric air pump, power on, and activate the pump.
- 1.3 Observe the inflatable soft light box until it reaches full inflation, then power off.
- 1.4 Replace the air valve cap after inflation.

## 2.AC air pump Deflation

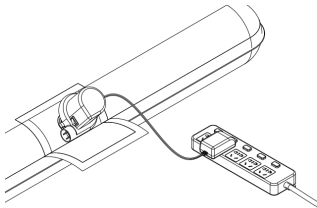

2. AC air pump Deflation Operation Method:

- 2.1 Open the deflation valve cap on the top of the light body.
- 2.2 Insert the air nozzle into the pump's “air inlet,” press the button to extract air.
- 2.3 After deflation, press the button to stop, then screw on the deflation valve cap.

## 3.DC pump Deflation

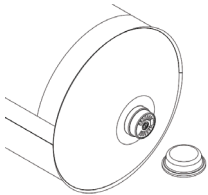

3. DC pump Inflation Operation Method:

- 3.1 Unscrew the inflation protective cap counterclockwise.
- 3.2 Press the button to inflate. Press again to stop inflation once fully inflated.
- 3.3 Screw the inflation protective cap clockwise.
- 3.4 Securely screw on the inflation protective cap.

# Product Structure

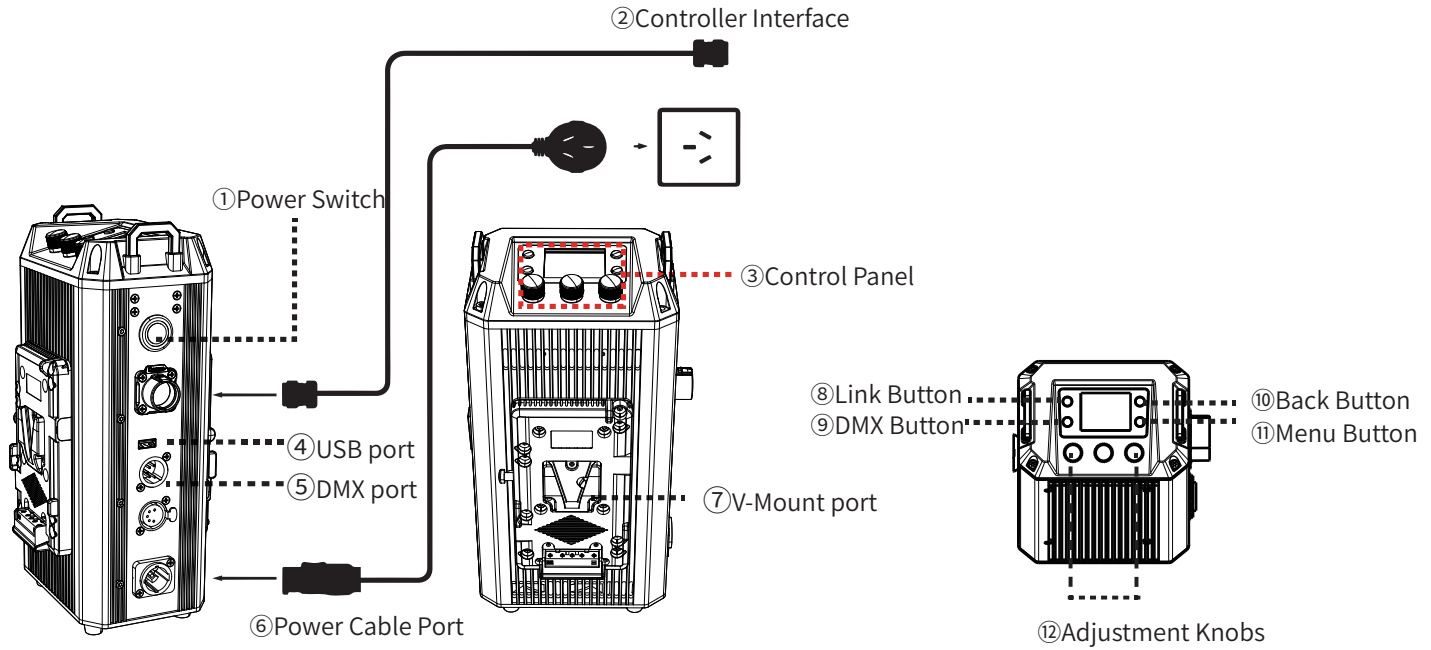

- ① Power Switch: Turns the controller on/off.
- ② Controller Interface: Connects to the inflatable light head.
- ③ Control Panel: Operates functions and displays data.
- ④ USB Port: Provides 5V voltage output.
- ⑤ DMX Port: Connects DMX cables for signal input/output.
- ⑥ Power Cable Port: Connects to AC power supply.
- ⑦ V-Mount Port: Connects to V-mount battery power.
- ⑧ Link Button: Short press for pairing, long press to disconnect.
- ⑨ DMX Button: Enters DMX interface to view the configuration table.
- ⑩ Back Button: Presses to return to previous interface.
- ⑪ Menu Button: Accesses the secondary menu. Pressing the Menu button repeatedly to cycles through secondary menu options.
- ⑫ Adjustment Knobs: Rotate to select function keys, tap to confirm. The rightmost knob can be used as a shortcut for the back button.

# Control Method

## 1. 2. 4G Connection Control

Press the controller power button briefly to turn on. Enter the default interface. First press the “Back” button to enter the controller main menu interface; rotate the “right knob” to “Settings,” press the “right knob” to confirm, and enter the corresponding secondary menu.

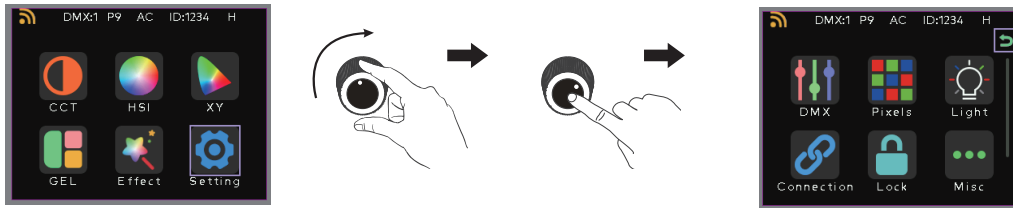

Rotate the “Right Knob” to “Connection,” press the “Right Knob” to confirm, and enter the corresponding interface. Rotate the “Right Knob” again to the connection mode box, press the “Right Knob” to confirm, and open the connection mode box.

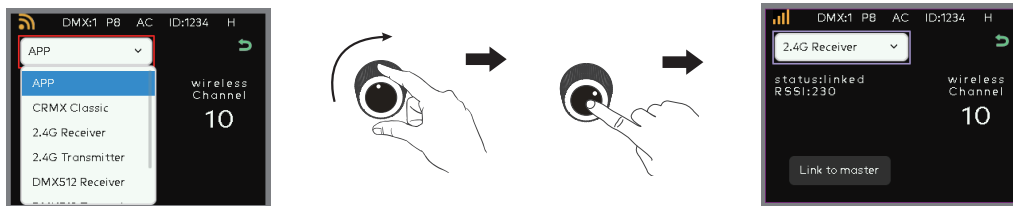

Rotate the “Right Knob” to “2.4G Receive,” press the “Right Knob” to confirm. To cancel pairing, long press the “Link” button.



This is the signal icon displayed after successful pairing in 2.4G connection mode.

## 1.2 Master-Slave Connection Control (Light A as master, Light B as slave)

Briefly press the controller's power button to turn it on, entering the default interface. First press the “Back” button to enter the controller's main menu interface. Rotate the “Right Knob” to “Settings,” press the “Right Knob” to confirm, and enter the corresponding submenu.

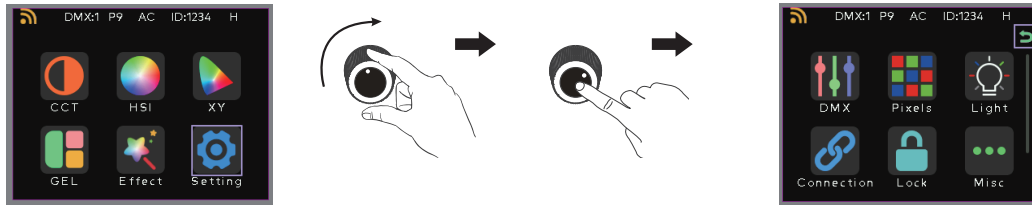

Light A: Rotate the “Right Knob” to “Connection,” press the “Right Knob” to confirm and enter the corresponding interface. Rotate the “Right Knob” to the connection mode box, press the “Right Knob” to confirm. Then rotate the “Right Knob” to “2.4G Send,” and briefly press the “Link” button to pair.

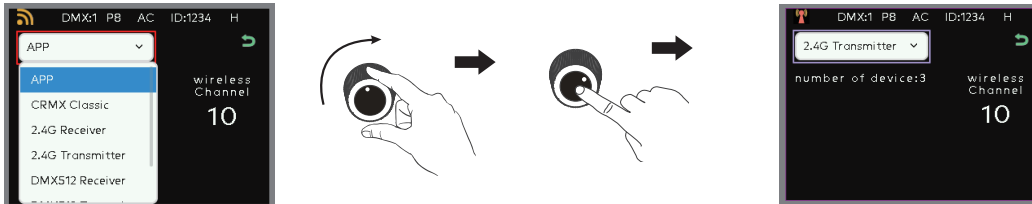

Light B: Rotate the “Right Knob” to ‘Connection’, press the “Right Knob” to confirm and enter the corresponding interface. Rotate the “Right Knob” to the Connection Mode box, press the “Right Knob” to confirm. Then rotate the “Right Knob” to “2.4G Receive”, press the “Right Knob” to confirm.

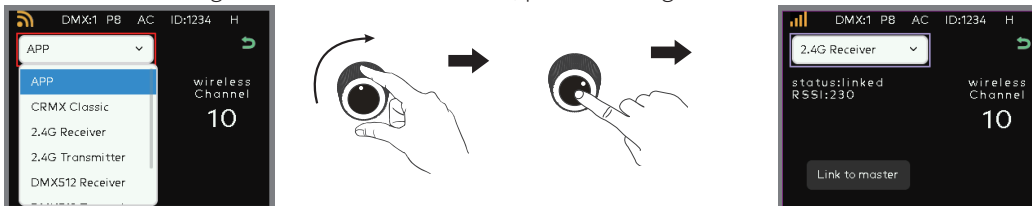

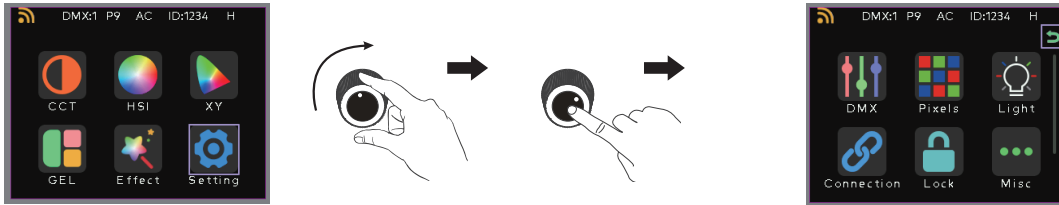

## 2. APP Connection and Control

Press the controller's power button briefly to turn it on. Upon entering the default interface, first press the “Back” button to access the controller's main menu. Rotate the “right knob” to “Settings,” then press the “right knob” to enter the corresponding submenu.

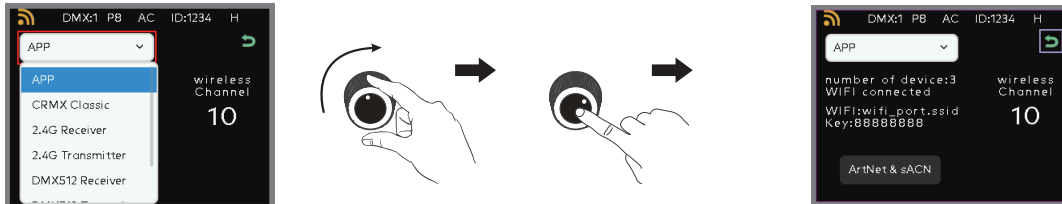

Lights: Rotate the “Right Knob” to “Connection,” press the “Right Knob” to confirm and enter the corresponding interface. Rotate the “Right Knob” to the connection mode box, press the “Right Knob” to confirm. Then rotate the “Right Knob” to ‘APP’ and press the “Right Knob” to confirm.



Mobile: Enable your phone's Wi-Fi, launch the Pheon Link app, navigate to Settings, tap the Wi-Fi icon, locate the controller ID you wish to connect to, tap Connect, enter the password “8888888”, and tap Connect. The appearance of the  icon indicates a successful connection.

### 3. Wired Console Connection Operation

Connect the console signal cable to the controller.

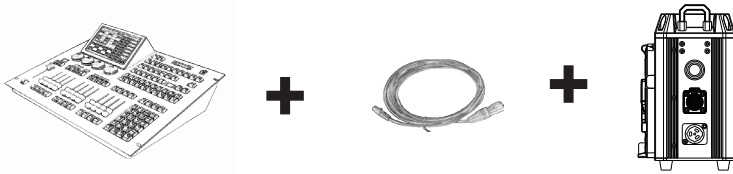

Briefly press the controller's power button to turn it on. Upon entering the default interface, first press the “Back” button to access the main menu. Rotate the “Right Knob” to “Settings,” then press the “Right Knob” to enter the corresponding submenu.

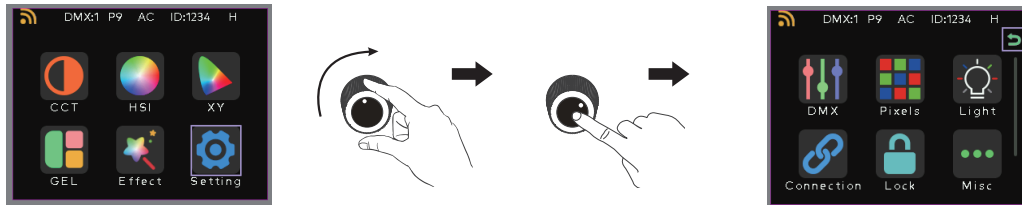

Rotate the “Right Knob” to “Connection,” press the “Right Knob” to enter the corresponding interface. Rotate the “Right Knob” to the connection mode box, press the “Right Knob” to confirm. Then rotate the “Right Knob” to “DMX512 Receive” and press the “Right Knob” to confirm.

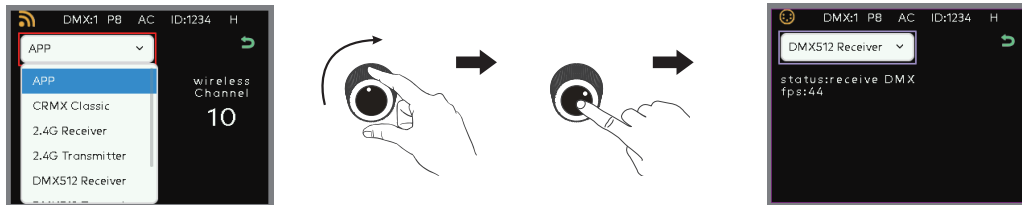

## 4. CRMX Classic connection Control

Connect the console signal cable to the transmitter. Open the transmitter's settings menu and select "DMX→CRMX Classic" as the control mode.

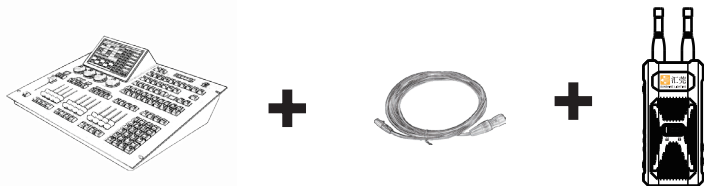

Briefly press the controller's power button to turn it on, entering the default interface. First press the "Back" button to enter the controller's main menu interface; rotate the "Right Knob" to "Settings", then press the "Right Knob" to enter the corresponding submenu.

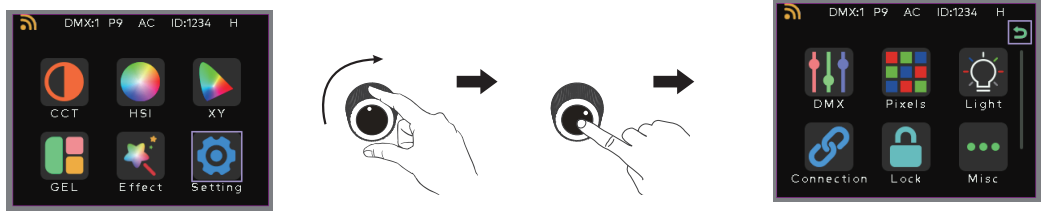

Rotate the "Right Knob" to "Connection," press the "Right Knob" to enter the corresponding interface. Rotate the "Right Knob" to the connection mode box, press the "Right Knob" to confirm. Then rotate the "Right Knob" to "CRMX Classic" and press the "Right Knob" to confirm.

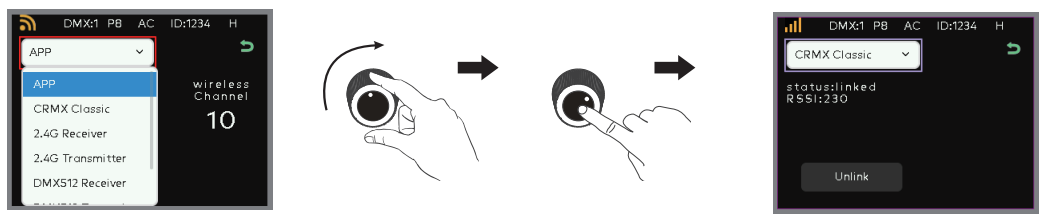

# Instruction Manual

1. Turn on the power switch, and the default interface will be the color temperature screen. Press “Back” to enter the main menu.
2. If the version interface displays as Figure 1, it needs to be upgraded to the new 1.2 version. (See P21 for upgrade instructions)

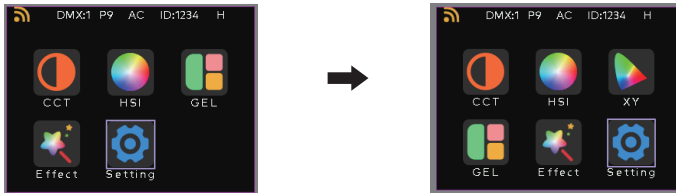

3. Rotate the “Right Knob” to “Color Temperature,” press the “Right Knob” to confirm, and enter the corresponding interface. The “Brightness,” “G/M,” and “Color Temperature” in the interface correspond to the three knobs below. Rotate the knobs to adjust the desired parameters.

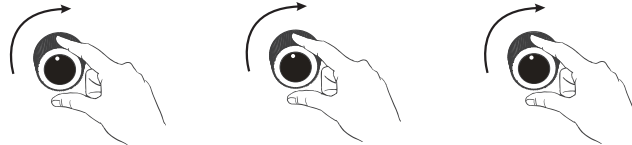

4. Press “Back” to return to the previous menu. Rotate the “Right Knob” to “Color Wheel,” then press the “Right Knob” to enter the corresponding interface. The “Brightness,” “Saturation,” and “Hue” controls in the interface correspond to the three knobs below. Rotate the knobs to adjust the desired parameters.

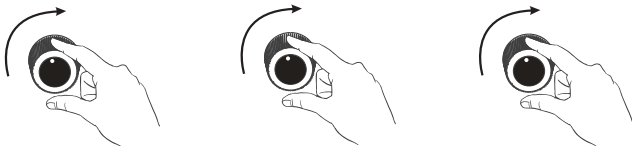
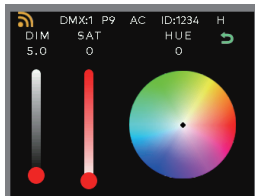

5. Press “Back” to return to the previous menu. Rotate the “Right Knob” to ‘XY’ and press the “Right Knob” to enter the corresponding interface. The “Brightness,” “Hue,” and “XY” settings in this interface correspond to the three knobs below. Rotate the knobs to adjust the desired parameters.

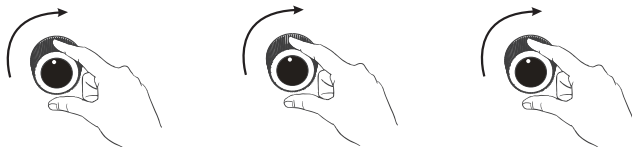

6. Press “Back” to return to the previous menu. Rotate the “Right Knob” to “Color Filter,” then press the “Right Knob” to enter the corresponding interface. Rotate the “Left Knob” to adjust “Brightness.” Rotate the “Right Knob” to select the desired “Color Temperature” and “Color Filter” color.

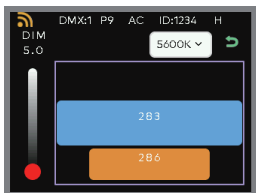

7. Press “Back” to return to the previous menu. Rotate the “Right Knob” to “Special Effects,” then press the “Right Knob” to enter the corresponding interface. The “Brightness,” “Speed,” and “Color” options in the interface correspond to the three knobs below. Rotate the knobs to adjust the desired parameters.

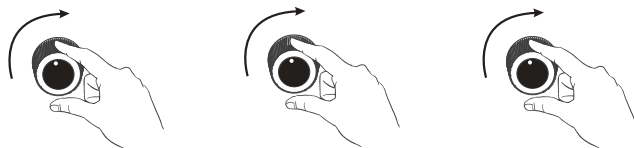
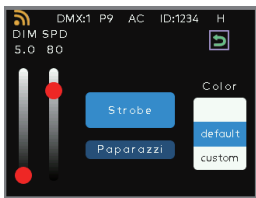

8. Press “Back” to return to the previous menu. Rotate the “Right Knob” to “Settings,” then press the “Right Knob” to enter the corresponding interface.

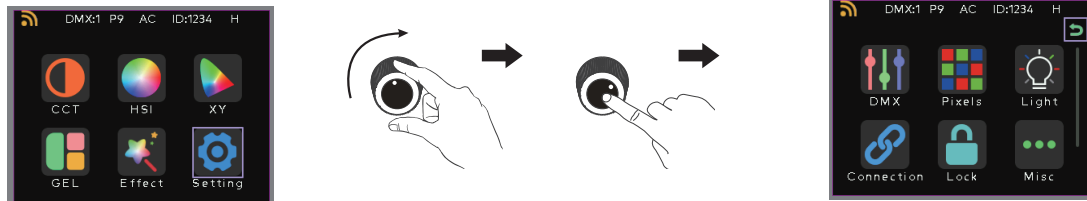

8.1 Rotate the “Right Knob” to “DMX,” then press the “Right Knob” to enter the corresponding interface. In the DMX interface, you can view the address code and other parameters.

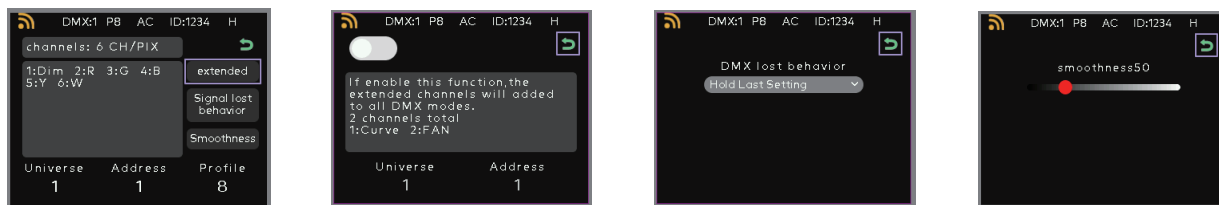

8.2 Press “Back” to return to the previous menu; rotate the “Right Knob” to ‘Pixel’, then press the “Right Knob” to enter the corresponding interface. The “Pixel Point” and “Direction” in the interface correspond to the three knobs below. Rotate the knobs to adjust the desired parameters.

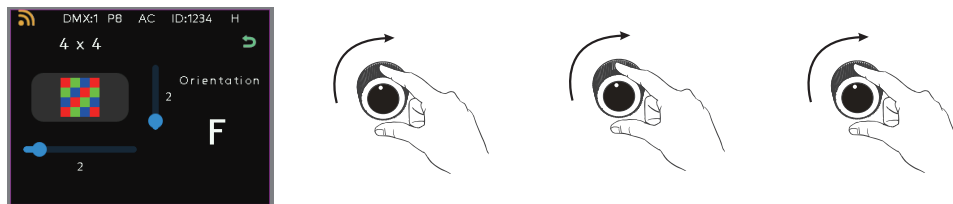

8.3 Press “Back” to return to the previous menu; rotate the “Right Knob” to “Light Mode”, then press the “Right Knob” to enter the corresponding interface.

Light Mode includes: Logarithmic, Linear, Exponential, and S modes, which can be switched and selected.

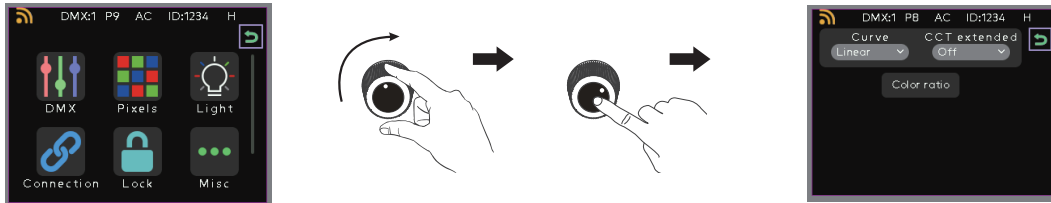

8.4 Press “Back” to return to the previous menu; rotate the “Right Knob” to “Connection,” then press the “Right Knob” to enter the corresponding interface. The interface includes multiple connection modes such as APP, CRMX, 2.4G, and DMX512. Select and connect by rotating the “Right Knob.”

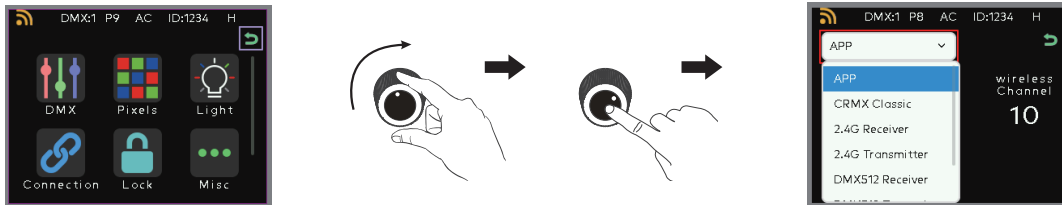

8.5 Press “Back” to return to the previous menu; rotate the “Right Knob” to ‘Lock’, then press the “Right Knob” to enter the corresponding interface. After entering the “Lock” interface, press and hold the “Menu” button in the lower right corner of the screen to exit.

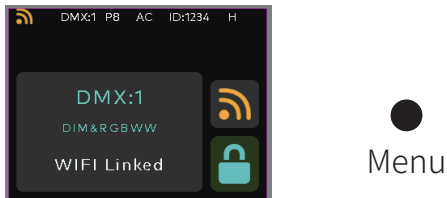

8.6 Press “Back” to return to the previous menu; rotate the “Right Knob” to ‘Other’ and press the “Right Knob” to enter the corresponding interface.

The “Fan Speed,” “Screen Brightness,” and “Language Mode” options in this interface correspond to the three knobs below. Rotate the knobs to adjust the desired parameters. Pressing the “Reset” option will restore the device to its factory state.

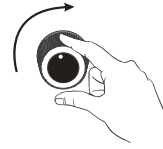
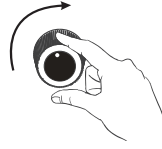
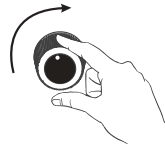
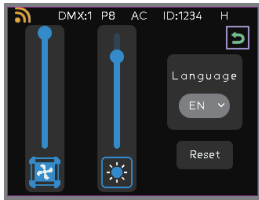

# ■ Frequently Asked Questions

## 1. Version Upgrade

After downloading the PHEON Link APP on your tablet/phone, enable Wi-Fi on your device. Go to Settings, click the WIFI button to enter the connection page, then select the device ID displayed on the light controller. Enter the connection password: 88888888 to connect. Once connected, open the APP, navigate to Settings > Upgrade > Click Upgrade.

For more information, scan the QR code



Lighting Library Download



APP User Manual



APP Download



# PHEON LUX<sup>®</sup>

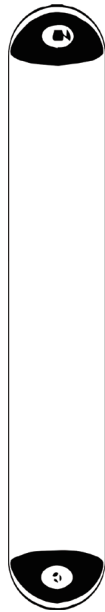
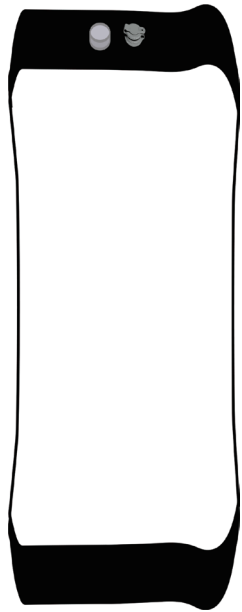

## AIR LUX MAX Series

