

Air Lux II Datasheet

M Series



M216-C



M44-C



M24-C



M22-C



M88-C



M48-C



M28-C

CONTENTS

1.Product features -----	01
2.Product introduction-----	01
3.Display interface -----	02
4.Connection method example-----	02
5.Lighting data-----	04
6.Color rendition-----	04
7.Precautions-----	05
8.After-sales service-----	05
9.Product Warranty Card-----	05
Appendix: Air Lux II Configuration Table-----	06

1.Product Features

①Light and soft ②RGBWW for light source ③Rich light control accessories ④Internal Wireless DMX ⑤AC100V-240V/ V-lock Battery

2.Product Introduction

2.1 product introduction

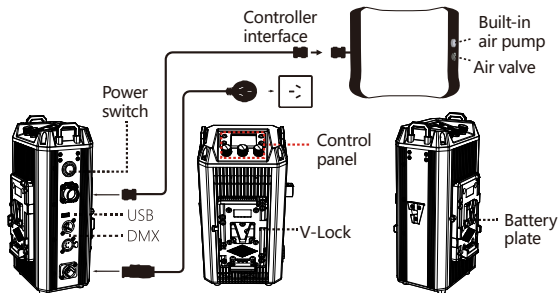

2.2 Air Inflation:

- ①Open the air valve protection cover on the top of the lamp body.
- ②Insert the air nozzle into the air outlet of the electric air pump and connect into the power supply.
- ③Open the electric air pump until the light is fully inflated. Cover the valve protection cover after the balloon light is fully inflated.

2.3 Built-in inflatable pump inflatable (optional):

- ①Unscrew the inflatable protection cover.
- ②Press the button to inflate.
- ③After filling, press the button to stop inflating.
- ④Screw on the inflatable protection cover.

2.4 Air release

- ①Open the gas valve drain protection cover on the top of the lamp.
- ②Press the lamp body to release the gas.
- ③Cover the protective cover and fold it for storage.

2.5Accessories List

- | | | | | |
|-----------------------|--------------|--------------|--------------------|-----------|
| ①lamp head | ②controller | ③lamp holder | ④signal cable | ⑤AC cable |
| ⑥rechargeable DC pump | ⑦AC air pump | ⑧eggcrate | ⑨vinyl trolley bag | |

3.Display menu interface

3.1 Settings interface



3.2 Settings interface



3.3 Control panel



①Pairing button: short press for pairing, long press for disconnecting

②DMX button: enter DMX interface

③Back button: return.

④Menu button: switch between secondary menu pages

⑤Adjustment knob: rotate to select function keys, press to confirm. The rightmost knob can be used as a shortcut for the back button.

4.Connection method example



Ballast setting options



ballast control mode options



ballast pairing button

(1) (1) A (host 24G sending) — B (host 24G receiving)

Light A (host 24G sending)Settings: ① select settings, ② select “2.4G sending” from the Mode menu. ③Press the pairing button briefly, and the screen will show that it is pairing.

Press and hold the pairing button to disconnect the linked light.

B (host 24G receiving)Settings: ①select settings ②select “2.4G sending” from the Mode menu.

③Press the pairing button briefly, and the screen will show that it is pairing. Press and hold the pairing button to disconnect the linked light.

(2) Signaler (host 2.4G sending) — Light (slave 2.4G receiving)

Signaler (host 2.4G sending) settings: Signaler control mode select “2.4G sending”

Light (slave 2.4G receiving) settings: ①select settings. ②select “2.4G receiving” from the mode menu

③press the pairing button briefly, and the screen will show that it is pairing. Press and hold the pairing button to disconnect the link.

(3) (Mobile phone (WIFI) — Signaler (APP) — Light (slave 2.4G receiving)

Signaler (APP) settings: Signaler control mode select “APP”

Light (slave 2.4G receiving) settings: ①select settings. ②select 2.4G receiving from the mode menu

③press the pairing button briefly, and the screen will show that it is pairing. Press and hold the pairing button to disconnect the link. Mobile phone (WIFI) settings: Search for the WiFi name of the ballast on the mobile phone WiFi and connect

(4) Phone (WIFI) — Light (APP)

Light (APP) settings: ①select settings. ②select “APP” in the mode menu

③short press the pairing button, the screen shows pairing. Long press the pairing button to disconnect the link

Phone (WIFI) settings: Search for the ballast WIFI name and connect on the phone’s WIFI.

(5) Phone (WIFI)-- Light A (APP)— Light B (Slave 2.4G Receiver)

Light A (APP) settings: ①select settings ②select “APP” in the mode menu the pairing button, the screen shows pairing. Long press the pairing button to disconnect the link

Light B (Slave 2.4G Receiver) settings: ①select settings ②select “2.4G Receiver” in the mode menu ③short press the pairing button, the screen shows pairing. Long press the pairing button to disconnect the link

Phone (WIFI) settings: Search for the ballast’s WIFI name and connect on the phone’s WIFI.

(6) Console (wired connection) — Transmitter (CRMX Classic) — Light (slave CRMX Classic)

Transmitter (CRMX Classic) settings: Select “CRMX Classic” in the transmitter control mode

Light (slave CRMX Classic) settings: ①select settings ②select “CRMX Classic” in the mode menu

③short press the pairing button, the screen shows pairing. Long press the pairing button to disconnect the link

(7) Console (WIFI)— Transmitter (APP)-- Light (slave 2.4G receiver)

Transmitter (APP) settings: Select “APP” in the transmitter control mode

Light (slave 2.4G receiver) settings: ①select settings ②select “2.4G receiver” in the mode drop-down menu

③short press the pairing button, the screen shows pairing. Long press the pairing button to disconnect the link

(8) Console (WIFI)— Light A (APP)— Light B (slave 2.4G receiver)

Light A (APP) settings: ①select settings ②select “APP” in the mode menu

③short press the pairing button, the screen shows pairing. Long press the pairing button to disconnect the link

Light B (slave 2.4G receiver) settings: ①select settings ②select “2.4G receiver” in the mode menu

③short press the pairing button, the screen shows pairing. Long press the pairing button to disconnect the link

(9) Light A (DMX512 sender)— Light B (DMX512 receiver) wired connection

Light A (DMX512 sender) settings: ①select settings. ②Select “DMX512 sender” in the mode menu

③short press the pairing button, the screen shows pairing. Long press the pairing button to disconnect the link.

Light B (DMX512 receiver) settings: ①select settings. ②select “DMX512 receiver” in the mode menu

③short press the pairing button, the screen shows pairing. Long press the pairing button to disconnect the link

(10) Console (wired connection)— Light (DMX512 receiver)

(DMX512 receiver) settings: ①select settings. ②select “DMX512 receiver” in the mode menu

③short press the pairing button, the screen shows pairing. Long press the pairing button to disconnect the link.

5. Lighting data

Light Source	RGBWW			
Voltage	AC 100V-240V DC 25V-60V			
Lux	M22-C (6000K)	0.5m 2270lux,	1m 797lux,	2m 240lux
	M24-C (6000K)	0.5m 3510lux,	1m 1390lux,	2m 439lux
	M28-C (6000K)	0.5m 4440lux,	1m 2210lux,	2m 829lux
	M44-C (6000K)	0.5m 5790lux,	1m 2690lux,	2m 924lux
	M48-C (6000K)	0.5m 7160lux,	1m 4040lux,	2m 1590lux
	M216-C(6000K)	0.5m 4880lux,	1m 2720lux,	2m 1300lux
	M88-C (6000K)	0.5m 9360lux,	1m6990lux,	2m 3270lux
Watt	M22-C 100w M48-C 800w	M24-C 200w M216-C 800w	M28-C 400w M88-C 1600w	M44-C 400w
CCT	2700K-10000K			
Beam Angle	210°			
Color Rendering Index	CRI/TLCI≥95			

6. Color rendition

Airlight Size	M22-C 660*610*150mm M24-C 1150*550*150mm M44-C 1170*1140*150mm M28-C 2190*550*150mm	M48-C 2200*1140*150mm M216-C 4200*550*150mm M88-C 2230*2230*150mm
Airlight Weight	M22-C 1kg ; M24-C 1.57kg ; M28-C 2.8kg ; M44-C 3kg ; M48-C 6.13kg ; M216-C 5.4kg ; M88-C 13.69kg	
Controller Size	M22-C/M24-C: 126*152*200mm M28-C/M44-C: 159*141*315mm M48-C/M216-C: 160*141*331mm M88-C:164*100*355mm	
Controller Weight	M22-C/M24-C: 1.664kg M28-C/M44-C: 2.785kg M48-C/M216-C: 3.45kg M88-C: 4.28kg	
Brightness Dimming	0%-100%	
Control Mode	APP Control, Controller Control , DMX512 Control, 2.4G Control, WIFI Control	
DMX Input/ Output	XLR 5 pin	
Support Wireless App Control , Wireless DMX Control (Need to buy a DMX Wireless Controller)		

7.Precautions

- Please read the manual carefully and understand all the contents before using.
- Please keep away from corrosive chemicals and liquids to avoid mechanical damage.
- Tidy up the power cord when using to avoid tripping and causing power disconnection or product damage.
- Do not disassemble the product by yourself, otherwise the warranty will be void. If the product is faulty, please refer it to an authorized technician for inspection or repair.
- Drop, external impact may cause product failure, man-made damage is not in the scope of our warranty.
- We have the final right to interpret the product. Product design and specifications are subject to change without notice.

8. After-sales service

- ①Sincerely thank you for choosing this product, as our users, you will be provided after-sales service: from the date of purchase, product quality problems free warranty within one year, lifelong maintenance only charge material costs.
- ② During the warranty period, due to the product's own failure, the company will provide you with free repair services, please do not disassemble the machine to repair yourself. Customers who exceed the warranty period still enjoy the quality after-sales service provided by our company.
- ③The following cases do not belong to free warranty service: man-made damage; disassembly, modification, repair without authorization; damage caused by external reasons (lightning, power supply, etc.); damage caused by incorrect installation or use by the user; damage to any wear-and-tear type accessories attached to the product; Out of warranty.

9. Product Warranty Card

User Name			
Address			
Contact Number			
Purchase Address			
Purchase Price			
Product Weight		Sales Order Number	
Name And Specification		Machine Number	
Dealer Signature		User Signature	

Air Lux II Configuration Table

Profile 1			
Channel	DMX Value	Function	Percent
1	0-255	Brightness (0~100%)	0-100
2	0-255	CCT(2700K~10000K)	0-100
3	G/M (-100 ~ +100)		
	0-20	0G	0-8
	21-33	100M	9-13
	34-134	99 M~ 1M	14-53
	135-145	0G	54-57
	146-244	1G~99G	58-96
	245-255	100G	97-100
4-5	0-255	HUE (0° ~359°)	0-100
6	0-255	SAT (0~100%)	0-100
7	GEL		
	0-20	None	0-8
	21-25	1700K	9-10
	26-30	2000K	11-12

Profile 1			
7	31-35	2700K	13-14
	36-40	3200K	15-16
	41-45	5600K	17-18
	46-50	Red(Hue 0°)	19-20
	51-55	Green(Hue 120°)	21-22
	56-60	Blue(Hue 240°)	23-24
	61-65	Magenta(Hue 340°)	25-26

Air Lux II Configuration Table

Profile 1			
	66-70	Yellow(Hue 30°)	27-28
	71-75	Orange(Hue 170°)	29-30
	76-255	Reserve	31-100
8	Effect		
	0-20	OFF	0-8
	21-25	Strobe	9-10
	26-30	Paparazzi	11-12
	31-35	Short-circuit	13-14
	36-40	Cop Car 1	15-16

Profile 1			
8	41-45	Cop Car 2	17-18
	46-50	Fire	19-20
	51-55	Rainbow	21-22
	56-60	Breath	23-24
	61-65	Pixel rainbow	25-26
	66-70	Meteor 1	27-28
	71-75	Meteor 2	29-30
	76-80	Meteor 3	31-32
	81-85	Music 1	33-34
	86-90	Music 2	35-36
	91-95	Random 1	37-38
	96-100	Random 2	39-40
	101-105	Random 3	41-42
	106-110	Stars	43-44
	111-115	Cop light 3	45-46

Air Lux II Configuration Table

Profile 1			
8	116-120	Cop light 4	47-48
	121-125	Mode 2	49-50
	126-130	Pile up	51-52
	131-135	Pile up 2	53-54
	136-140	Fire	55-56
	141-255	Reserve	57-100
9	Speed Rate		
	0-20	50%	0-8
	21-255	0-100%	9-100
10	Effect Color		
	0-20	Default (white)	0-8
	21-50	Random color	9-20
	51-80	Rainbow (0-359° recycle)	21-31
	81-110	Custom (defined by other channels)	32-43
	111-255	Default (white)	44-100

Profile1			
11	0-255	R	0-100
12	0-255	G	0-100
13	0-255	B	0-100
14	0-255	W	0-100
15	0-255	Y	0-100
16	Curves		
	0-15	Linear	0-6
	16-75	Logarithmic	7-31
	76-135	Linear	32-55

Air Lux II Configuration Table

Profile 1			
	136-195	Index	56-79
	196-255	None	80-100

Profile 2			
Channel	DMX Value	Function	Percent
1	0-255	Brightness (0~100%)	0-100
2	0-255	CCT (2700K~10000K)	0-100
3	G/M (-100 ~ +100)		
	0-20	0G	0-8
	21-33	100M	9-13
	34-134	99 M~ 1M	14-53
	135-145	0G	54-57
	146-244	1G~99G	58-96
	245-255	100G	97-100
4	0-255	HUE (0° ~359°)	0-100
5	0-255	SAT (0-100%)	0-100

Profile 3			
Channel	DMX Value	Function	Percent
1	0-255	Brightness (0~100%)	0-100
2	0-255	CCT (2700K~10000K)	0-100
3	G/M (-100 ~ +100)		
	0-20	0G	0-8
	21-33	100M	9-13

Air Lux II Configuration Table

Profile 3			
3	34-134	99 M~ 1M	14-53
	135-145	0G	54-57
	146-244	1G~99G	58-96
	245-255	100G	97-100
4	0-255	Cross fade	0-100
5	0-255	R(0-255)	0-100
6	0-255	G(0-255)	0-100
7	0-255	B(0-255)	0-100

Profile 4			
Channel	DMX Value	Function	Percent
1	0-255	Brightness (0~100%)	0-100
2	0-255	CCT(2700K~10000K)	0-100
3	0-255	HUE(0° ~359°)	0-100
4	0-255	SAT(0~100%)	0-100

Profile 5			
Channel	DMX Value	Function	Percent
1	0-255	Brightness (0~100%)	0-100
2	0-255	CCT (2700K~10000K)	0-100
3	0-255	Cross fade(0~100%)	0-100
4	0-255	R	0-100
5	0-255	G	0-100
6	0-255	B	0-100

Air Lux II Configuration Table

Profile 6

Channel	DMX Value	Function	Percent
1	0-255	Brightness (0~100%)	0-100
2	0-255	R	0-100
3	0-255	G	0-100
4	0-255	B	0-100

Profile 7

Channel	DMX Value	Function	Percent
1	0-255	Brightness (0~100%)	0-100
2	0-255	R	0-100
3	0-255	G	0-100
4	0-255	B	0-100
5	0-255	W	0-100

Profile 8

Channel	DMX Value	Function	Percent
1	0-255	Brightness (0~100%)	0-100
2	0-255	R	0-100
3	0-255	G	0-100
4	0-255	B	0-100
5	0-255	Y	0-100
6	0-255	W	0-100

Air Lux II Configuration Table

Profile 9

Channel	DMX Value	Function	Percent
1	0-255	R	0-100
2	0-255	G	0-100
3	0-255	B	0-100

Profile 10

Channel	DMX Value	Function	Percent
1	0-255	R	0-100
2	0-255	G	0-100
3	0-255	B	0-100
4	0-255	W	0-100

Profile 11

Channel	DMX Value	Function	Percent
1	0-255	R	0-100
2	0-255	G	0-100
3	0-255	B	0-100
4	0-255	CCT(2700K~10000K)	0-100